



RENTAL FACTORY
**STANDARD
FACTORY
BUILDING**



FOR YOUR BUSINESS SOLUTION

Currently eleven units have been built with 3 types of sizes;

- ▶ Type A : 1,068/1,740 sqm
- ▶ Type B : 2,274/4,122 sqm
- ▶ Type C : 1,206/1,092 sqm

Factory Buildings for Rent - Standard Factory Buildings built to assist investors in their search for factory buildings. Its strategic location is on the main boulevard of the Greenland International Industrial Center (GIOC) providing easy accessibility for industry players. Rental Factory can be functioned as food, packaging, accesories factory, etc. Your wish of owning as factory and conducting industrial activities could start here. Start with any suitable factory type for your business.

Type A
 Building Size 1.068 m²
 Land Size 1.740 m²

Type B
 Building Size 2.274 m²
 Land Size 4.122m²

Type C
 Building Size 1.206 m²
 Land Size 1.092 m²

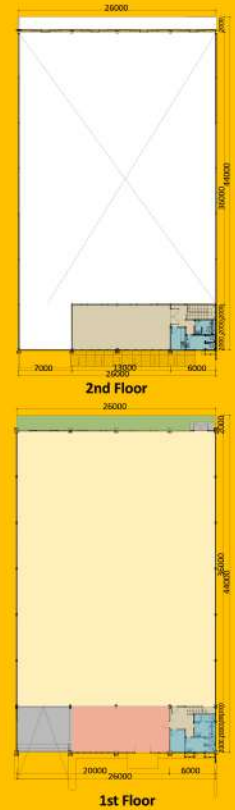

Type A
 Type B
 Type C

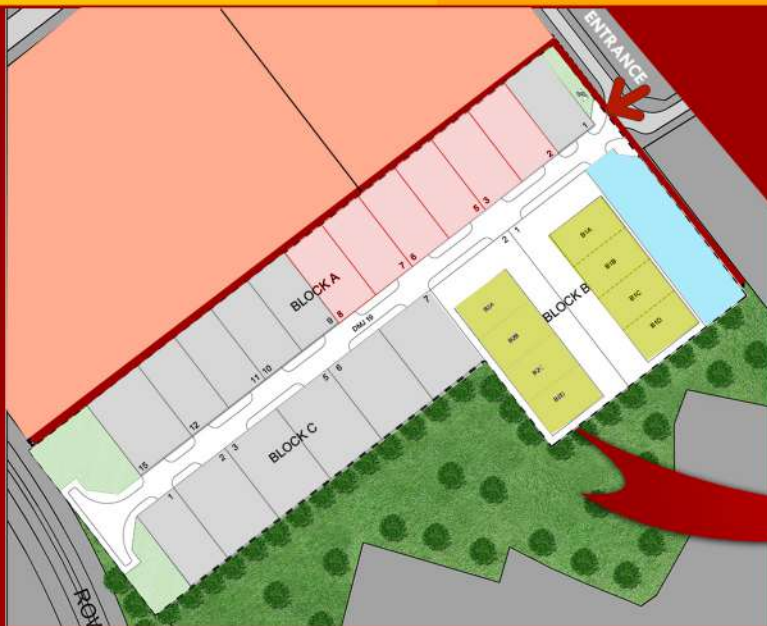

Specification

Foundation	: Square Pile
Building Structure	: Steel frame
Wall	: Painted, plastered, fine coated red bricks, and metal frame, Aluminium Composite Panel
Door frame	: Aluminium
Floor	: Office Room : Homogeneous tile/ceramics or equivalent Production Room : Concrete with loading capacity of 3 tons/m ²
Roof	: Steel frame with Zinc Metal Roof
Sanitary	: Ex KOHLER or equivalent
Power supply	: PLN 33.000 VA
Clean Water	: Clean water PDAM standard
Telephone line	: 2 lines inside building
Roof Height	: ±10 meter

Data, illustrations and specification featured in this brochures are based on situation and condition in planning timespan and subject to change without prior notice.
 The Developer reserves the right to modify any parts of the building prior to completion as directed or approved by appropriate authorities. While every reasonable care has been taken in preparing this brochure, the Developer and Design Studio cannot be held responsible for any inaccuracy in this contents.